

Lakeside Homes

GARDENIA



CONTEMPORARY RANCH HOME

Gracious living with modern amenities and single-story convenience

New construction • 3 bedroom • 2.5 bath • 2,517 ft² • 3+ car garage

The Gardenia is part of a series of collaborations between Lakeside, the area's premier luxury home builder, and Karen Kempf Interiors, the highly sought-after interior design company. This energy-efficient, contemporary ranch is thoughtfully designed, both inside and out, and well-appointed for contemporary living.



Inquiries

(262) -241-2300

lakesidedevelopment.com

Products have been intentionally chosen for their quality, style and superior reputation.

EXTERIOR FEATURES

Focus On Energy® Qualified Home

R-21 High-Density Fiberglass Batt Insulation at walls

R-50 Loose Fill Cellulose Insulation at ceiling where possible

Reinforced 9'-0" Poured Concrete Foundation

LP® Smartside® Siding and Trim

Halquist Thin Cut Stone

Pella® Impervia® Casement Windows

C.H.I. Stamped Carriage House Garage Doors

INTERIOR FEATURES

Interior designed by Karen Kempf Interiors

Vaulted Ceiling in the Great Room

Shaw Inspirations Engineered Hardwood Floor

Dura Supreme Cabinetry w/Soft Close Doors and Drawers

Quartz Countertops Throughout

Jenn-Air Appliances

Superior Direct Vent Fireplace

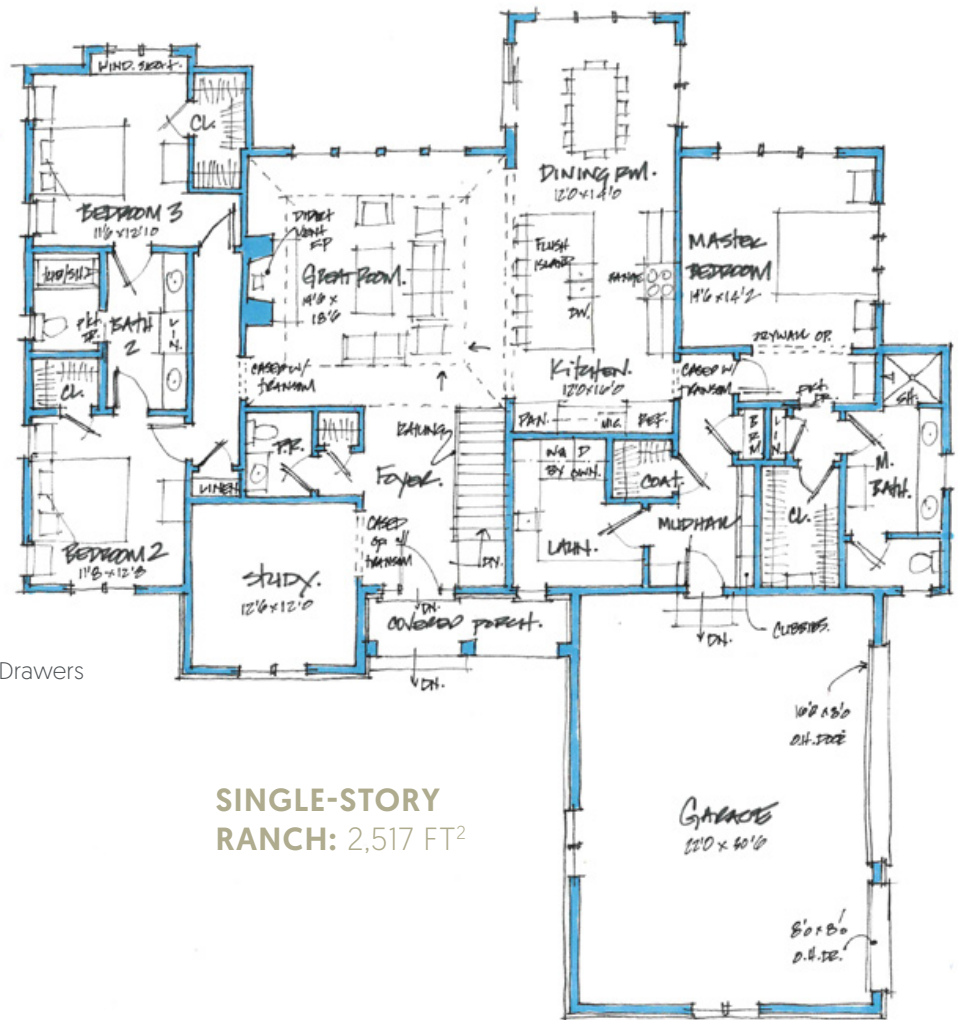

SINGLE-STORY RANCH: 2,517 FT²

